

Series 20 - Party Wall DPC

Date: 12/05/2021

Reference: 3

Issue: 2



GIS Party Wall DPC is designed for vertical application to suit both Masonry/Blockwork and Masonry/Timberframe construction applications. **GIS Party Wall DPC** is designed to prevent the spread of flames and smoke as well as reducing the spread of sound along the cavity at the party wall junction. **GIS Party Wall DPC** is designed to meet current fire and building regulations and are rigorously tested to current accreditation and provides up to 2 hours fire integrity.

GIS Party Wall DPC is 1200mm long and is manufactured from Knauf ECOSE Mineral Wool and is encapsulated in recycled plastics on a DPC backing.



GIS SOCK TECHNICAL DATA

FIRE

GIS Party Wall DPC is manufactured using Knauf ECOSE Rock Slab which has a fire classification of EUROCCASS A1 tested to BSEN13501-1 which is encapsulated in recycled plastic which will not add to the propagation of a fire the DPC backing is made to BS6515:84. All **GIS Party Wall DPC** is tested in application to BSEN1366-4 as was BS476: Part 20 using current fire test methods.

ACOUSTICS

GIS Party Wall DPC meets the generic requirements for the prevention of flanking noise transmission, along external walls and party wall cavities. Meeting approved document E of the building regulations.

THERMAL

GIS Party Wall DPC have a thermal conductivity of 0.035W/mK and when fitted will provide an effective perimeter edge seal as stated in building regulations L1A and L2A as well as meeting section 6 of the Scottish building standards.

COMPLIANCE

GIS Party Wall DPC when correctly fitted meet the requirements laid out in part E of robust detail.

For masonry in a separating wall/party wall, E-WM 1-21 is met.

For Timber Frame in a separating wall/party wall E-WT 1-4 is met and in a separating floor application E-FT 1-6 is met.

For concrete in separating floor applications E-FC 1-14 is met.

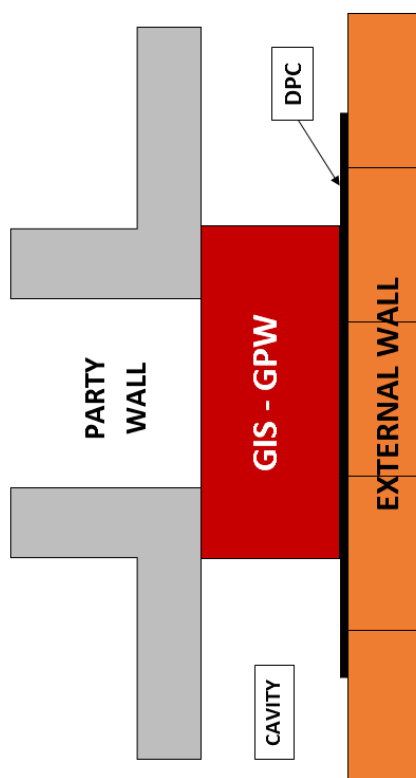

Contact:
sales@gisuk.co
Tel: 01827 219327

Address:
William Nadin Way, Swadlincote,
Derbyshire, DE11 0BB



Series 20 - Party Wall DPC

Date: 19/01/2021

Reference: 3

Issue: 2

ENVIRONMENT

Guardian Insulation Solutions Environmental policy is designed to reduce waste and reduce our carbon footprint. All products used are chosen for helping us, as a company, to achieve this goal. The KNAUF INSULATIONS ECOSE mineral wool slab meets these requirements. The ECOSE technology used is the first organic binder in the UK for mineral wool. The ECOSE slabs are free from CFCs, HCFCs and contain no other material elements which have ozone depletion potential. Thus they exceed the requirements of BREEAM entering a classification of ZERO ODP as well as ZERO GWP. Where low environmental impact is a key design consideration these products help achieve this goal.



EXTERNAL CORNER APPLICATION

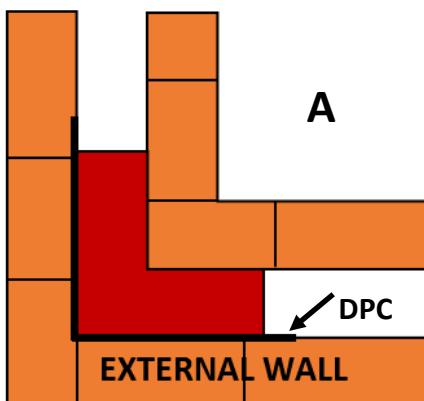

INTERNAL CORNER APPLICATION

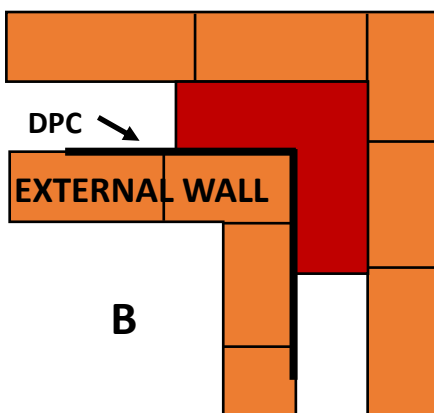

GIS PARTY WALL DPC INSTALLATION

GIS 1200mm long Party Wall DPC can be used in both brick/block and brick/timber frame party wall applications.

When installing GIS Party Wall DPC they are designed to be compression fitted at the party wall junction vertically during construction. When fitting extra care must be taken to ensure all butt joints are tightly fitted this is to maintain the fire and acoustic integrity of the product. A minimum of 50mm overlap with the party wall leaf on either side of the party wall cavity must be maintained to meet current fire and acoustic requirements.

It is critical that the GIS Party Wall DPC fills the cavity from the rear of the outer leaf to the face of the inner leaf, any cavity insulation must be cut back at either side of the party wall in the outer cavity to allow this fitting method.

When fitting vertically the 100mm end lap must be fitted at the bottom, then as the build progresses the lap forms a continual barrier preventing the ingress of moisture.

GIS PARTY WALL DPC HANDLING

GIS Party Wall DPC are packaged in outer polythene bags for transport and ease of handling. The product must not be stored in direct sunlight as this may cause the plastic to degrade. It is recommended that the goods are covered or stored indoors if standing for a period of time prior to use. Local delamination from the DPC may occur during handling this does not affect the performance of the product when fitted as it is under compression. Internal and external corners are two piece sets, price on application see drawings A & B.

Contact:
sales@gisuk.co
Tel: 01827 219327

Address:
William Nadin Way, Swadlincote,
Derbyshire, DE11 0BB

SUIT CAVITY SIZE mm	GPW STANDARD RANGE ON 337mm DPC				GPW 250mm WIDE RANGE ON 337mm DPC			
	ORDER REF	PACK QTY	TOTAL mm THICKNESS	PACKS PER PALLET	ORDER REF	PACK QTY	TOTAL mm THICKNESS	PACKS PER PALLET
40-50	GPW/40-50	8	60	16	GPW250/40-50	8	60	15
51-65	GPW/51-65	8	70	16	GPW250/51-65	8	70	15
66-75	GPW/66-75	8	80	15	GPW250/66-75	6	80	16
76-90	GPW/76-90	6	100	18	GPW250/76-90	6	100	16
91-100	GPW/91-100	6	110	18	GPW250/91-100	6	110	15
101-110	GPW/101-110	6	120	15	GPW250/101-110	6	120	15
111-120	GPW/111-120	4	130	20	GPW250/111-120	4	130	15
121-130	GPW/121-130	4	140	20	GPW250/121-130	4	140	16
131-140	GPW/131-140	4	150	17	GPW250/131-140	4	150	16
141-150	GPW/141-150	4	160	16	GPW250/141-150	4	160	15
151-165	GPW/151-165	4	175	14	GPW250/151-165	3	175	16
166-180	GPW/166-180	4	190	14	GPW250/166-180	3	190	16
181-200	GPW/181-200	3	210	14	GPW250/181-200	3	210	14
201-220	GPW/201-220	3	230	12	GPW250/201-220	2	230	18
221-240	GPW/221-240	2	250	18	GPW250/221-240	2	250	18
241-260	GPW/241-260	2	275	18	GPW250/241-260	2	275	16
261-280	GPW/261-280	2	300	15	GPW250/261-280	2	300	16
281-300	GPW/281-300	2	320	15	GPW250/281-300	2	320	16

SUIT CAVITY SIZE mm	GPW 300mm WIDE RANGE ON 450mm DPC				GPW 450mm WIDE RANGE ON 600mm DPC			
	ORDER REF	PACK QTY	TOTAL mm THICKNESS	PACKS PER PALLET	ORDER REF	PACK QTY	TOTAL mm THICKNESS	PACKS PER PALLET
41-50	GPW300/40-50	8	60	15	GPW450/40-50	5	60	16
51-60	GPW300/51-65	8	70	15	GPW450/51-65	4	70	16
61-65	GPW300/66-75	6	80	15	GPW450/66-75	5	80	14
66-75	GPW300/76-90	6	100	15	GPW450/76-90	4	100	14
76-80	GPW300/91-100	6	110	14	GPW450/91-100	3	110	16
81-85	GPW300/101-110	6	120	14	GPW450/101-110	4	120	14
86-90	GPW300/111-120	4	130	15	GPW450/111-120	3	130	14
91-95	GPW300/121-130	4	140	15	GPW450/121-130	3	140	14
96-100	GPW300/131-140	4	150	15	GPW450/131-140	3	150	12
101-110	GPW300/141-150	4	160	15	GPW450/141-150	3	160	12
111-115	GPW300/151-165	3	175	15	GPW450/151-165	2	175	15
116-120	GPW300/166-180	3	190	15	GPW450/166-180	2	190	15
121-125	GPW300/181-200	3	210	12	GPW450/181-200	2	210	13
126-130	GPW300/201-220	2	230	18	GPW450/201-220	2	230	12
131-135	GPW300/221-240	2	250	15	GPW450/221-240	2	250	12
136-140	GPW300/241-260	2	275	15	GPW450/241-260	2	275	10
141-145	GPW300/261-280	2	300	14	GPW450/261-280	2	300	10
146-150	GPW300/281-300	2	320	14	GPW450/281-300	2	320	9