

Series 10T - Top Hat

Date: 19/01/2021

Reference: 2

Issue: 1

GIS Top Hats are a combi sock designed to suit party wall applications within general construction situations from extended cavity brick/block, timber frame and metal frame structures. GIS Top Hats are designed to prevent the spread of flames and smoke as well as reducing the spread of sound along cavities. GIS Top Hats are designed to meet and exceed current fire & building regulations and provide up to 4 hours fire integrity both with DPC (external wall use) and without. GIS Top Hats are 1200mm long and manufactured They are made by combining GDS250/300 sock and GDS100 and wrapped



TECHNICAL DATA



FIRE

GIS Top Hats are manufactured using Knauf ECOSE rock slab which has a fire classification of EUROCLASS A1 tested to BSEN 13501-1 which is formed with water based glue encapsulated in recycled plastic. All GIS Top Hats are manufactured combining two parts of two fire socks which are tested in application to BSEN 1366-4 (BS476 Part 20) using current fire test methods. Tested for cavities up to 200mm both vertical & horizontal assessed using test report BMT/FF/1F/15078 both with or without DPC.

ACOUSTICS

GIS Top Hats meet the generic requirements for the prevention of flanking noise transmission, along external and separating wall cavities. Meeting approved document E (2014) of the building regulations, for England, Wales & Ireland. (Based on width range for application) 200mm, 250mm, 300mm or other widths POA. Thermal flat wide or side T.

THERMAL

GIS Duo Top Hats have a thermal conductivity of 0.037W/mK and when fitted will provide an effective perimeter edge seal as stated in building regulations L1A and L2A as well as meeting section 6 of the Scottish building standards.

COMPLIANCE

GIS Top Hats when correctly fitted meet the requirements laid out in part E of robust detail.

For masonry in a separating wall/party wall, E-WM 1-21 is met.

For Timber Frame in a separating wall/party wall E-WT 1-4 is met in a separating floor application E-FT 1-6 is met and for concrete in separating floor applications E-FC 1-14 is met.

Contact:
sales@gisuk.co
Tel: 01827 219327

Address:
William Nadin Way, Swadlincote,
Derbyshire, DE11 0BB

Series 10T - Top Hat

Date: 19/01/2021

Reference: 2

Issue: 1

ENVIRONMENT

Guardian Insulation Solutions Environmental policy is designed to reduce waste and reduce our carbon footprint. All products used are chosen for helping us, as a company, to achieve this goal. The KNAUF INSULATIONS ECOSE mineral wool slab meets these requirements. The ECOSE technology used is the first organic binder in the UK for mineral wool. The ECOSE slabs are free from CFCs, HCFCs and contain no other material elements which have ozone depletion potential. Thus they exceed the requirements of BREEAM entering a classification of ZERO ODP as well as ZERO GWP. Where low environmental impact is a key design consideration these products help achieve this goal.

APPLICATIONS

GIS Top Hat DPC is designed for use where the party wall junction meets an external cavity. The DPC is to prevent the ingress of moisture across the cavity as required in building regulations.

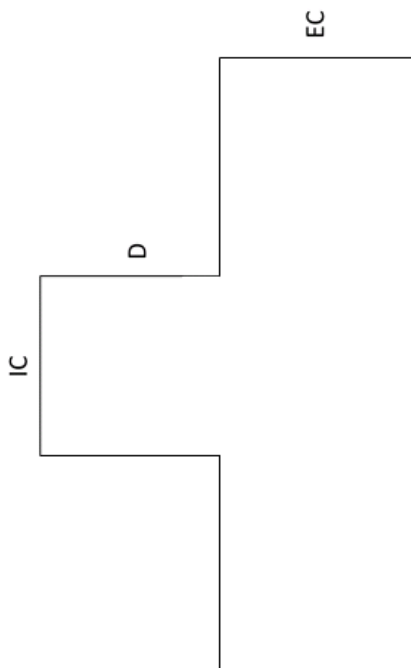

GIS TOP HAT INTERNAL WALLS AS BELOW

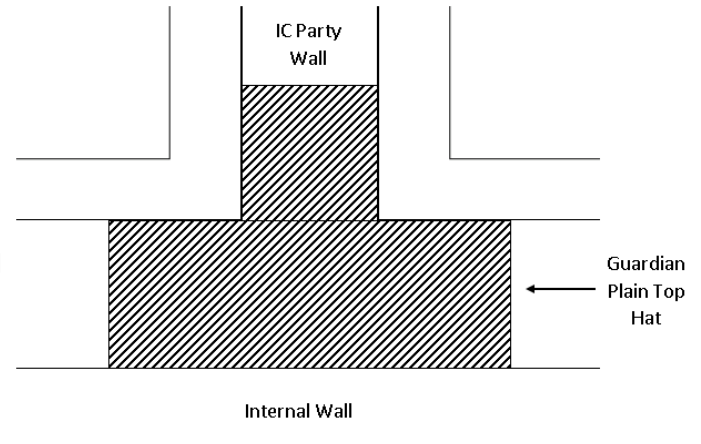

GIS TOP HAT USED AGAINST OUTER WALL AS BELOW

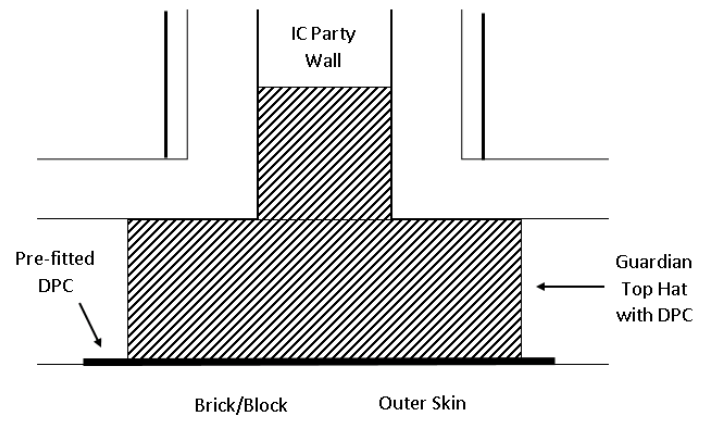

INSTALLATION

GIS Top Hats are installed under compression in all applications to meet fire tested requirements. This is to ensure they are a friction fit within both the external and party wall. GIS Top Hats should be tightly butted together, no gaps must be left. Cut lengths where needed must be tightly butted cut sides used on end only. With a steel frame building other fire barriers may be needed if dependant on wall construction. Please submit drawings to ensure it complies.

HANDLING

GIS Top Hats are packaged in outer polythene bags for transport and ease of handling. The product must not be stored in direct sunlight as this may cause the plastic to degrade. It is recommended that the goods are covered or stored indoors if standing for a period of time prior to use.

Contact:
sales@gisuk.co
Tel: 01827 219327

Address:
William Nadin Way, Swadlincote,
Derbyshire, DE11 0BB

Part No. (With DPC)	Part No. (Plain)	External Cavity (mm)	Internal Party Wall (mm)	T	EC	D	IC	DPC
GIS/TH/DPC/50/50/200	GIS/TH/50/50/200	50	50	200	65	99	65	337
GIS/TH/DPC/50/50/250	GIS/TH/50/50/250	50	50	250	65	99	65	337
GIS/TH/DPC/60/50/200	GIS/TH/60/50/200	60	50	200	75	99	65	337
GIS/TH/DPC/60/50/250	GIS/TH/60/50/250	60	50	250	75	99	65	337
GIS/TH/DPC/75/50/200	GIS/TH/75/50/200	75	50	200	85	99	65	337
GIS/TH/DPC/75/50/250	GIS/TH/75/50/250	75	50	250	85	99	65	337
GIS/TH/DPC/100/75/250	GIS/TH/100/75/250	100	75	250	110	99	85	337
GIS/TH/DPC/100/75/300	GIS/TH/100/75/300	100	75	300	110	99	85	450
GIS/TH/DPC/125/75/250	GIS/TH/125/75/250	125	75	250	135	99	85	337
GIS/TH/DPC/125/75/300	GIS/TH/125/75/300	125	75	300	135	99	85	450
GIS/TH/DPC/150/75/250	GIS/TH/150/75/250	150	75	250	160	99	85	337
GIS/TH/DPC/150/75/300	GIS/TH/150/75/300	150	75	300	160	99	85	450
GIS/TH/DPC/100/100/250	GIS/TH/100/100/250	100	100	250	110	99	110	337
GIS/TH/DPC/100/100/300	GIS/TH/100/100/300	100	100	300	110	99	110	450
GIS/TH/DPC/125/100/250	GIS/TH/125/100/250	125	100	250	135	99	110	337
GIS/TH/DPC/125/100/300	GIS/TH/125/100/300	125	100	300	135	99	110	450
GIS/TH/DPC/125/125/250	GIS/TH/125/125/250	125	125	250	135	99	135	337
GIS/TH/DPC/125/125/300	GIS/TH/125/125/300	125	125	300	135	99	135	450
GIS/TH/DPC/140/100/250	GIS/TH/140/100/250	140	100	250	150	99	110	337
GIS/TH/DPC/140/100/300	GIS/TH/140/100/300	140	100	300	150	99	110	450
GIS/TH/DPC/140/125/250	GIS/TH/140/125/250	140	125	250	150	99	135	337
GIS/TH/DPC/140/125/300	GIS/TH/140/125/300	140	125	300	150	99	135	450
GIS/TH/DPC/150/100/250	GIS/TH/150/100/250	150	100	250	160	99	110	337
GIS/TH/DPC/150/100/300	GIS/TH/150/100/300	150	100	300	160	99	110	450
GIS/TH/DPC/150/125/250	GIS/TH/150/125/250	150	125	250	160	99	135	337
GIS/TH/DPC/150/125/300	GIS/TH/150/125/300	150	125	300	160	99	135	450
GIS/TH/DPC/175/100/300	GIS/TH/175/100/300	175	100	300	190	120	110	450
GIS/TH/DPC/175/125/300	GIS/TH/175/125/300	175	125	300	190	120	135	450
GIS/TH/DPC/175/150/300	GIS/TH/175/150/300	175	150	300	190	120	160	450
GIS/TH/DPC/200/100/300	GIS/TH/200/100/300	200	100	300	220	120	110	450
GIS/TH/DPC/200/125/300	GIS/TH/200/125/300	200	125	300	220	120	135	450
GIS/TH/DPC/200/150/300	GIS/TH/200/150/300	200	150	300	220	120	160	450

Other sizes are available to suit customers custom sized cavities POA